



**LEGEND:**

-  = EXISTING CONTOUR
-  = PROPOSED CONTOUR

**SUFFOLK COUNTY TAX MAP**

DISTRICT 0900  
 SECTION 179.00  
 BLOCK 01.00  
 PARCEL 027.001

**FLYING POINT ROAD**

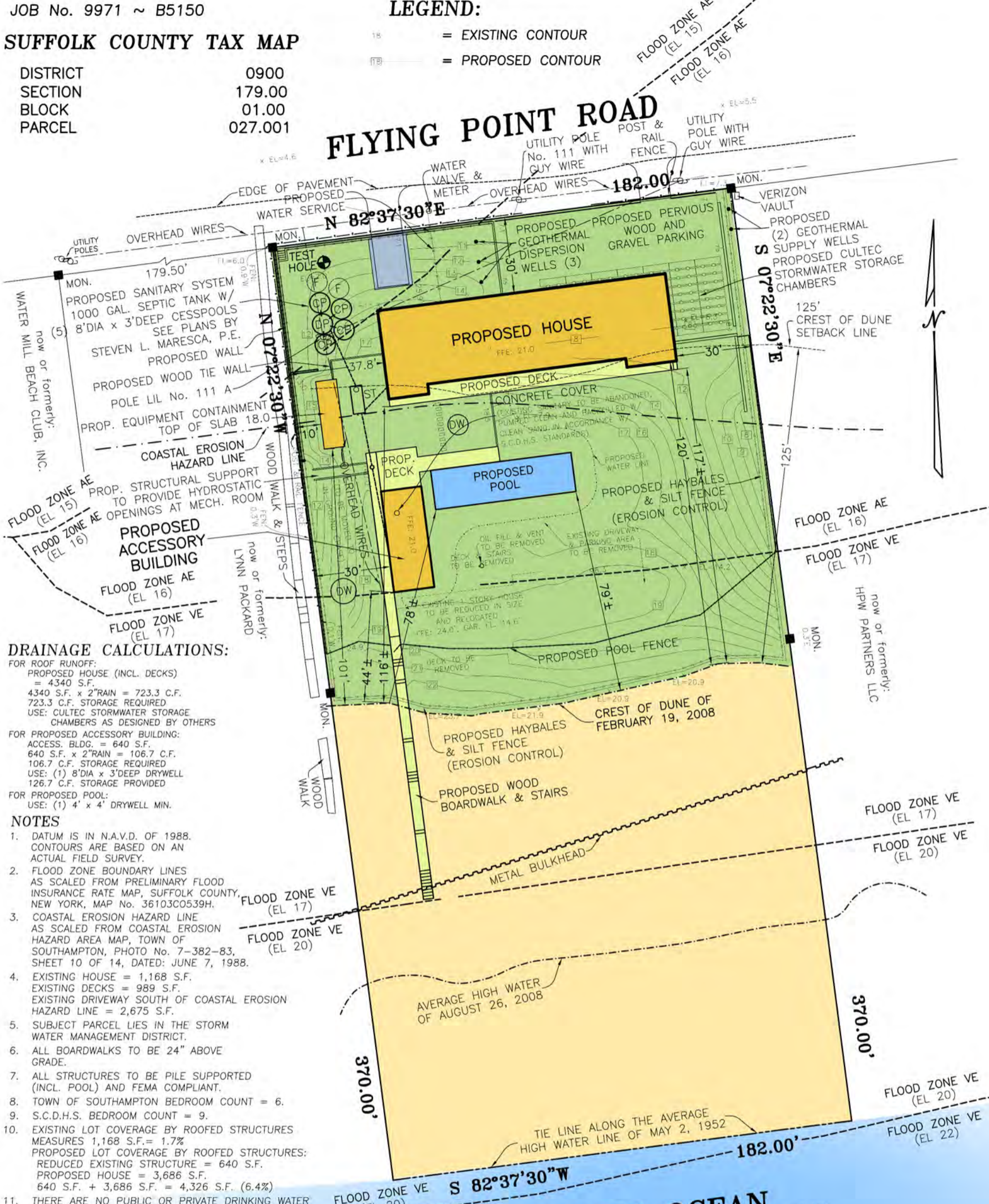

**DRAINAGE CALCULATIONS:**

**FOR ROOF RUNOFF:**  
 PROPOSED HOUSE (INCL. DECKS)  
 = 4340 S.F.  
 4340 S.F. x 2"RAIN = 723.3 C.F.  
 723.3 C.F. STORAGE REQUIRED  
 USE: CULTEC STORMWATER STORAGE CHAMBERS AS DESIGNED BY OTHERS

**FOR PROPOSED ACCESSORY BUILDING:**  
 ACCESS. BLDG. = 640 S.F.  
 640 S.F. x 2"RAIN = 106.7 C.F.  
 106.7 C.F. STORAGE REQUIRED  
 USE: (1) 8'DIA x 3'DEEP DRYWELL  
 126.7 C.F. STORAGE PROVIDED

**FOR PROPOSED POOL:**  
 USE: (1) 4' x 4' DRYWELL MIN.

**NOTES**

1. DATUM IS IN N.A.V.D. OF 1988. CONTOURS ARE BASED ON AN ACTUAL FIELD SURVEY.
2. FLOOD ZONE BOUNDARY LINES AS SCALED FROM PRELIMINARY FLOOD INSURANCE RATE MAP, SUFFOLK COUNTY, NEW YORK, MAP No. 36103C0539H.
3. COASTAL EROSION HAZARD LINE AS SCALED FROM COASTAL EROSION HAZARD AREA MAP, TOWN OF SOUTHAMPTON, PHOTO No. 7-382-83, SHEET 10 OF 14, DATED: JUNE 7, 1988.
4. EXISTING HOUSE = 1,168 S.F. EXISTING DECKS = 989 S.F. EXISTING DRIVEWAY SOUTH OF COASTAL EROSION HAZARD LINE = 2,675 S.F.
5. SUBJECT PARCEL LIES IN THE STORM WATER MANAGEMENT DISTRICT.
6. ALL BOARDWALKS TO BE 24" ABOVE GRADE.
7. ALL STRUCTURES TO BE PILE SUPPORTED (INCL. POOL) AND FEMA COMPLIANT.
8. TOWN OF SOUTHAMPTON BEDROOM COUNT = 6.
9. S.C.D.H.S. BEDROOM COUNT = 9.
10. EXISTING LOT COVERAGE BY ROOFED STRUCTURES MEASURES 1,168 S.F. = 1.7%  
 PROPOSED LOT COVERAGE BY ROOFED STRUCTURES:  
 REDUCED EXISTING STRUCTURE = 640 S.F.  
 PROPOSED HOUSE = 3,686 S.F.  
 640 S.F. + 3,686 S.F. = 4,326 S.F. (6.4%)
11. THERE ARE NO PUBLIC OR PRIVATE DRINKING WATER WELLS WITHIN 150' OF PROPOSED SEPTIC SYSTEM.

REVISED: JULY 26, 2013 (REV. EQUIP. STRUCT.)  
 REVISED: JULY 3, 2013 (REV. ELEV. DATUM)  
 REVISED: MARCH 25, 2013 (PROP. SLAB ELEV.)  
 REVISED: DECEMBER 20, 2012 (EQUIP. SETBACK TO PROPERTY LINE)  
 REVISED: NOVEMBER 29, 2012 (POOL EQUIP. SETBACK TO DUNE)  
 REVISED: OCTOBER 26, 2012 (PROPOSED WALLS, DECK, DRAINAGE & GRADING)  
 REVISED: FEBRUARY 16, 2012 (STRUCTURAL SUPPORT)  
 REVISED: JANUARY 24, 2012 (REV. RESIDENTIAL SITE PLAN)  
 REVISED: MARCH 16, 2011 (PROP. POOL & ACCESSORY BLDG. LOC.)  
 REVISED: OCTOBER 25, 2010 (REV. RESIDENTIAL SITE PLAN)  
 REVISED: AUGUST 17, 2009 (REV. PROPOSED SANITARY LAYOUT)  
 REVISED: JULY 29, 2009 (REV. PROPOSED HOUSE & SANITARY)  
 REVISED: APRIL 13, 2009 (REV. RESIDENTIAL SITE PLAN)  
 REVISED: MARCH 4, 2009 (REV. GRADING, WALKWAYS, POOL & POOL FENCE)  
 REVISED: DECEMBER 1, 2008 (REV. PROPOSED SANITARY LOCATION)  
 REVISED: NOVEMBER 26, 2008 (REV. WALKWAY, NOTES & LABELS)  
 REVISED: NOVEMBER 21, 2008 (RESIDENTIAL SITE PLAN)  
 REVISED: NOVEMBER 6, 2008 (REV. TOPOGRAPHY)  
 REVISED: OCTOBER 21, 2008 (LOC. TEST HOLE W/ ELEV.)  
 REVISED: AUGUST 26, 2008 (LOC. BULKHEAD & SHORELINE)  
 REVISED: JUNE 19, 2008 (TEST HOLE & DRIVEWAY AREA)  
 SURVEYED: FEBRUARY 19, 2008

**ATLANTIC OCEAN**

**MAP OF PROPERTY  
 FOR  
 TONY CHENG  
 SITUATE  
 WATER MILL**

TOWN OF SOUTHAMPTON  
 SUFFOLK COUNTY, NEW YORK

AREA = 67,340 S.F. (1.546 ACRES)  
 (TO TIE LINE)

SCALE: 1" = 40'

LESTER HOLDEN, L.S. No. 49548  
 S. H. W. AND S., LAND SURVEYORS, P.C.  
**SQUIRES, HOLDEN, WEISENBACHER & SMITH**  
 LAND SURVEYING ~ LAND PLANNING ~ ENGINEERING  
 SOUTHAMPTON ~ NEW YORK