

SURVEY OF PROPERTY
 PROPERTY LOCATED IN THE INC. VILLAGE OF SAGAPONACK
 TOWN OF SOUTHAMPTON
 SUFFOLK COUNTY, NEW YORK
 S.C.T.M. # 908-010-04-39.1
 AREA = 29,834 SF. = 0.6849 ACRES
 SCALE: 1"=30'

NOTE: THE EXISTENCE OF RIGHT OF WAYS,
 WETLANDS AND/OR EASEMENTS OF RECORD
 IF ANY, NOT SHOWN ARE NOT GUARANTEED.

F.E.M.A. FLOOD ZONE 'X'
 PROPERTY ZONED: R-120

REFER TO S.C.D.H.S. STANDARDS DATED NOVEMBER 13, 1995
 FOR SEPTIC TANK AND LEACHING POOL REQUIREMENTS AND
 COMPONENT DETAILS.

EXISTING RESIDENCE TO BE REMOVED
 EXISTING WELL AND SEPTIC TO BE ABANDONED AND REMOVED

PROPOSED DWELLING TO HAVE EIGHT (8) BEDROOMS MAXIMUM.
 SEPTIC TANK TO BE 2000 GALLON TYPICAL.

USE THREE (3) 18" DIAMETER, 6' HIGH PRECAST CONCRETE
 LEACHING RINGS, WITH ROOM FOR 50% EXPANSION.

BACKFILL MATERIAL SHALL BE COARSE SAND AND GRAVEL.

BOTTOM OF POOLS SHALL BE A MINIMUM OF 3' ABOVE
 MAXIMUM EXPECTED GROUNDWATER ELEVATION.

TEST HOLE DATA

(NOT TO SCALE)
 BY: BUTCH PAYNE
 8-5-15 - GRADE EL. = 18.0'

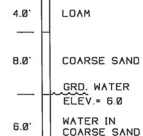

NOTE: SPOT ELEVATIONS RESULT FROM AN
 ACTUAL FIELD SURVEY AND REFER TO
 N.A.V.D. 1988

UNAUTHORIZED ALTERATION OR ADDITION TO THIS SURVEY IS A VIOLATION
 OF SECTION 7289 OF THE NEW YORK STATE EDUCATION LAW.

COPIES OF THIS SURVEY MAP NOT BEARING THE LAND SURVEYORS INKED
 OR EXPOSED SEAL SHALL NOT BE CONSIDERED TO BE A VALID TRUE COPY.

GUARANTEES OR CERTIFICATIONS INDICATED HEREON SHALL RUN ONLY TO
 THE PERSON FOR WHOM THE SURVEY IS PREPARED, AND ON HIS BEHALF TO
 THE TITLE COMPANY, GOVERNMENTAL AGENCY AND LENDING INSTITUTION
 LISTED HEREON, AND TO THE ADDRESSES OF THE LENDING INSTITUTION.
 GUARANTEES OR CERTIFICATIONS ARE NOT TRANSFERABLE TO ADDITIONAL
 INSTITUTIONS OR SUBSEQUENT OWNERS.

LAND N/F
 J. DAHL
 (RES W/WELL)
 R09-07-135

SANITARY SYSTEM DETAIL
 (NO SCALE)

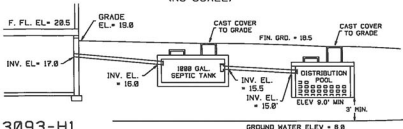

3093-H1

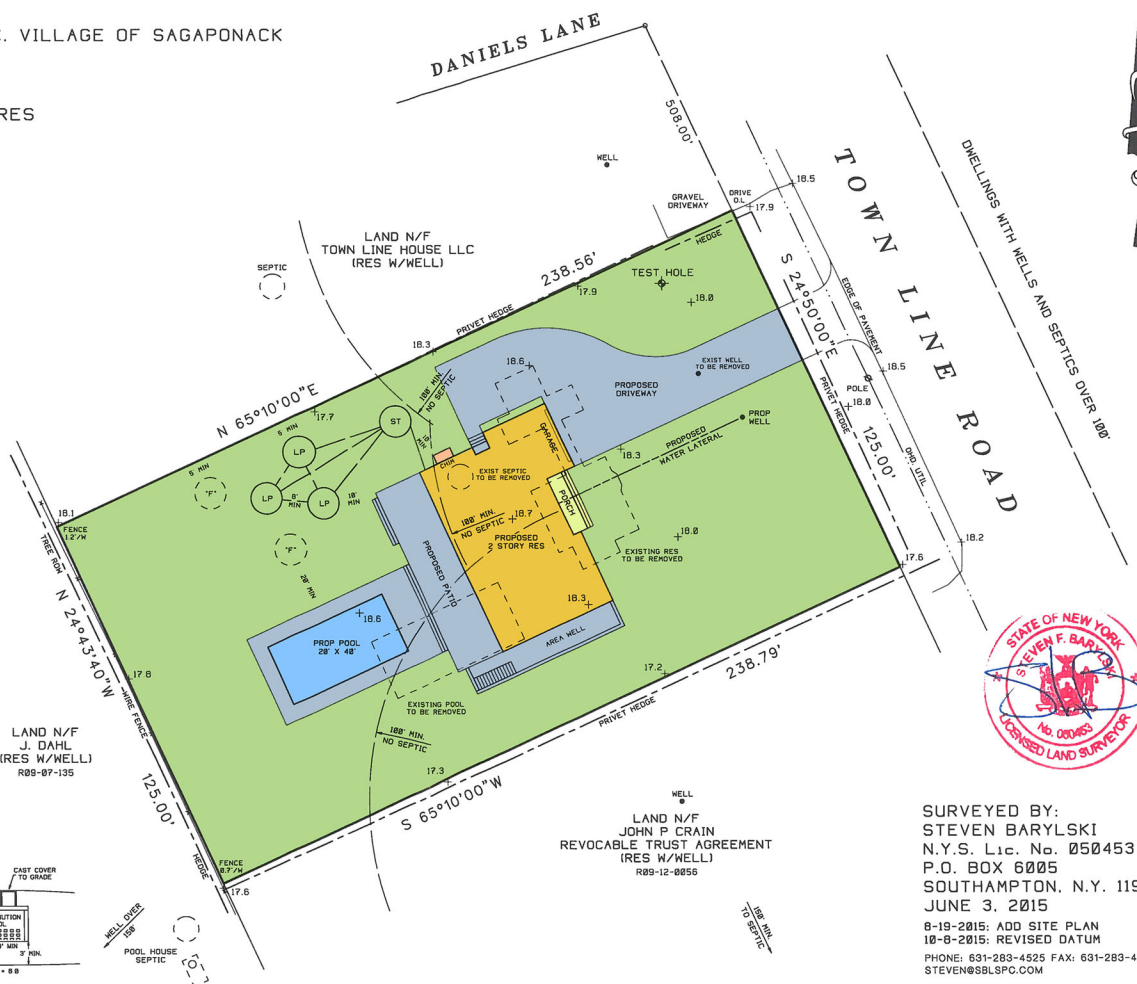

WELL
 LAND N/F
 JOHN P CRAIN
 REVOCABLE TRUST AGREEMENT
 (RES W/WELL)
 R09-12-0056

SURVEYED BY:
 STEVEN BARYLSKI
 N.Y.S. Lic. No. 050453
 P.O. BOX 6005
 SOUTHAMPTON, N.Y. 11969
 JUNE 3, 2015
 8-19-2015: ADD SITE PLAN
 10-9-2015: REVISED DATUM
 PHONE: 631-283-4525 FAX: 631-283-4784
 STEVEN@SBLSP.COM



P:\0306\03063093-H1.dwg - 10/06/2015 - 01:04 PM - Scale: 1"=300.00'